



# MODEL H5381

## 1½ HP ELECTRIC MOTOR

### INSTRUCTIONS

For questions or help with this product contact Tech Support at (570) 546-9663 or techsupport@grizzly.com

#### Model H5381 Specifications

Power ..... 1½ HP  
 Cycle..... 60Hz  
 Voltage..... 110/220V  
 Prewired ..... 110V  
 Amps ..... 17/8.5A  
 RPM..... 1725  
 Phase ..... Single  
 Class..... B

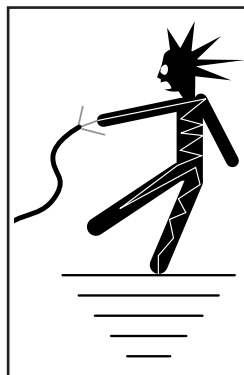

#### ! WARNING

Electrocution or fire could result if this motor is not grounded correctly or if your wire connections do not comply with local and state codes. Ensure compliance by checking with a qualified electrician!

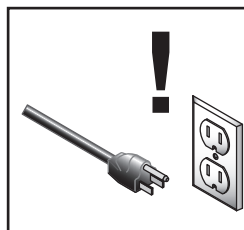

#### ! WARNING

Disconnect power when replacing motor. Failure to do this may result in serious personal injury.

#### Replaceable Parts

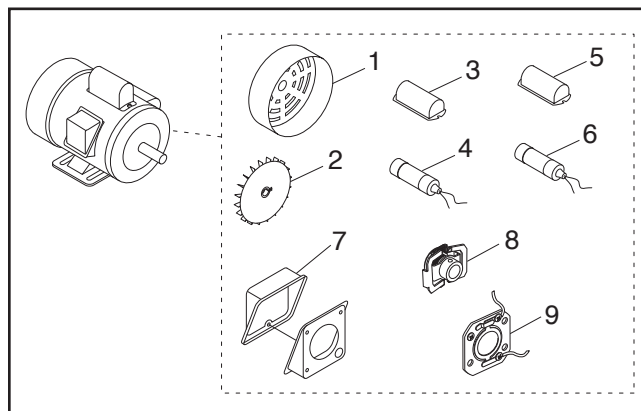

#### REF PART # DESCRIPTION

1	PH5381001	MOTOR FAN COVER
2	PH5381002	MOTOR FAN
3	PH5381003	S CAPACITOR COVER
4	PH5381004	S CAPACITOR 400M 125V 1-7/8 X 3-3/8
5	PH5381005	R CAPACITOR COVER
6	PH5381006	R CAPACITOR 50M 250V 1-5/8 X 2-3/4
7	PH5381007	JUNCTION BOX
8	PH5381008	CENTRIFUGAL SWITCH
9	PH5381009	CONTACT PLATE

#### Making Wire Connections

If you are unsure how to attach wires to terminals, DO NOT continue. Contact an electrician for assistance. Connecting wires improperly may cause them to come loose or contact other wires, which can cause electrocution, fire, or a short.

COPYRIGHT © DECEMBER, 2007 BY GRIZZLY INDUSTRIAL, INC., REVISED JUNE, 2024 (LW)  
 NO PORTION OF THIS INSTRUCTION SHEET MAY BE REPRODUCED IN ANY SHAPE  
 OR FORM WITHOUT THE WRITTEN APPROVAL OF GRIZZLY INDUSTRIAL, INC.  
 (FOR MODELS MFD. SINCE 08/24) #JB10225 PRINTED IN TAIWAN

V2.06.24

\*\*\*Keep for Future Reference\*\*\*

# H5381 Wiring Diagram

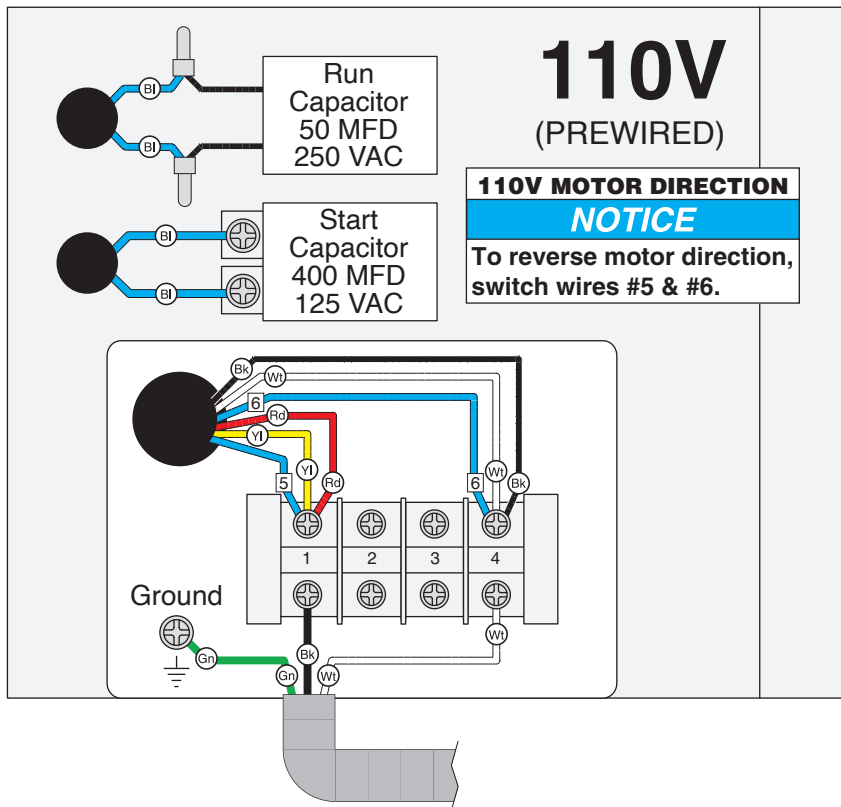

COLOR KEY	
BLACK	Bk
WHITE	Wt
GREEN	Gn
RED	Rd
YELLOW	Yl
BLUE	Bl

**NOTICE**

The motor wiring shown here is current at the time of printing, but it may not match your motor. Always use the wiring diagram inside the motor junction box.

