



MODEL T10040 FRONT BASKET FOR ATV INSTRUCTION SHEET

Specifications

Outside Dimensions36"W x 17¼"D x 6⅜"H
 Inside Dimensions 34½"W x 15½"D x 5¼"H
 Material.....Welded Steel
 Finish.....Powder Coating

Inventory (Figures 1 and 2)

A.	Basket	1
B.	Filler Plate	1
C.	Hex Bolts M6-1 x 16 (Filler Clamps)	2
D.	Washers 6mm (Mounting)	16
E.	Lock Nuts M6-1 (Mounting)	10
F.	Hex Bolts M6-1 x 80 (Mounting)	8
G.	Filler Plate Clamps	2
H.	Mounting Brackets.....	8

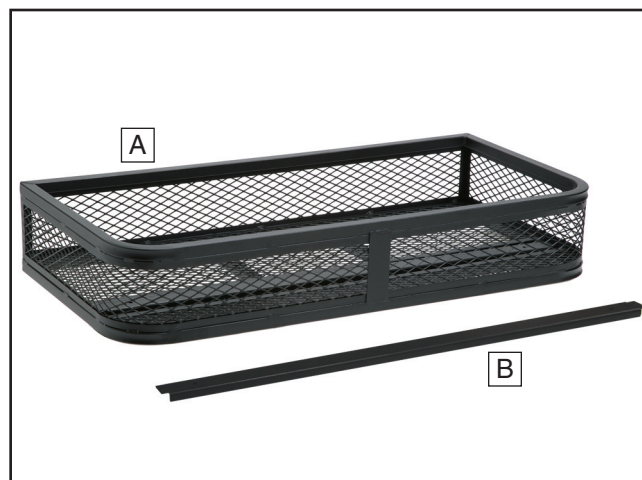

Figure 1. Inventory.

⚠ CAUTION

To reduce the risk of injury from using this product:

- Read and understand all instructions before using this product.
- Do not modify this basket in any way.
- Do not allow people or animals to ride in the basket.
- Do not exceed the ATV manufacturer's rack weight carrying capacity when loading this product.
- Keep all hardware tightened to be sure the rack is securely mounted.
- Do not mount the basket where it will interfere with the ATV controls.

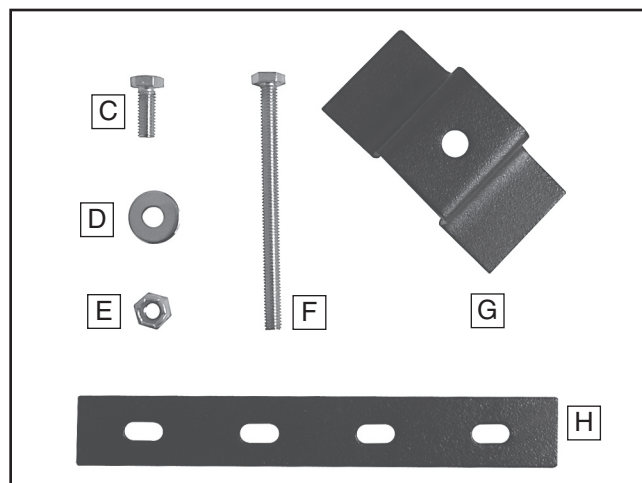

Figure 2. Inventory.

ASSEMBLY

Assembly for the Model T10040 is only required for certain ATV rack designs. Determine whether your existing ATV rack is completely flat or if it has vertical upright portions. If your existing ATV rack has upright portions, skip ahead to **Installation**, otherwise, continue below.

To assemble the basket for a flat rack without uprights:

1. Secure the filler plate to the basket using the M6-1 x 16 screws, the filler plate clamps, and two M6-1 lock nuts, as shown in **Figures 3** and **4**.

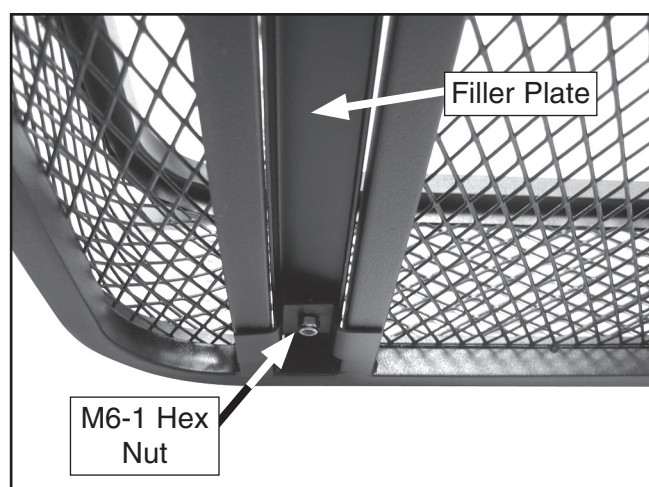

Figure 3. Filler plate installation.

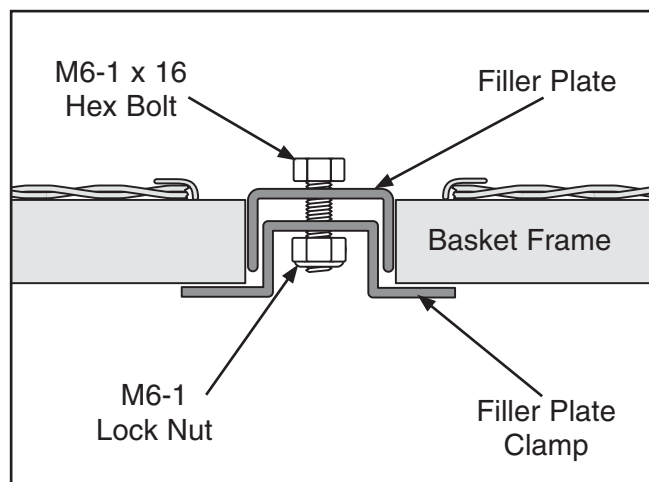

Figure 4. Filler plate illustration.

INSTALLATION

- If you have determined that your existing rack has no uprights, then position the basket on the existing ATV rack and proceed directly to **Step 1**.
- If your existing rack has upright portions, then use the integrated slot in the basket to position the model T10040 over the existing upright on the ATV rack, as shown in **Figure 5**.

Note: *The Model T10040 may not accommodate all ATV rack styles. Depending on the size and style of the existing ATV rack, the rack may have to be removed before installation.*

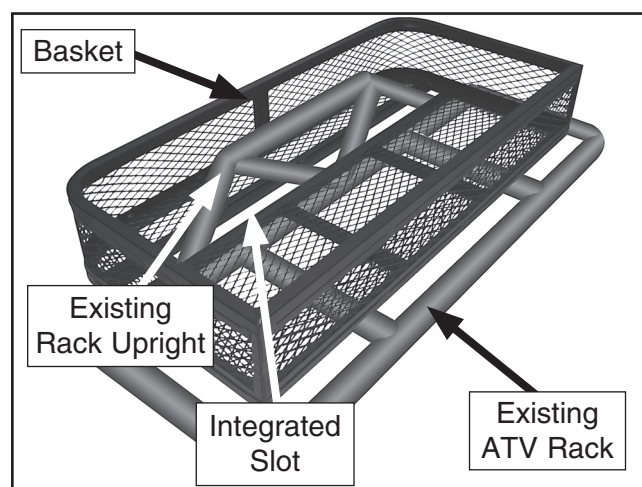

Figure 5. Basket placement.

To install the basket:

1. Locate four suitable mounting points on the existing ATV rack. These points should be near the four corners of the basket and solidly attached to the ATV.

Note: *Make sure the positioning of the basket will not interfere with any of the ATV controls.*

CAUTION

Be certain that the control and function of the ATV are not compromised in any way by the position of the basket. Failure to do so could result in loss of control while driving the ATV.



- Secure each corner of the basket to the existing ATV rack using two mounting brackets, two M6-1 x 80 hex bolts, four 6mm washers and two M6-1 lock nuts, as shown in **Figures 6 and 7**.

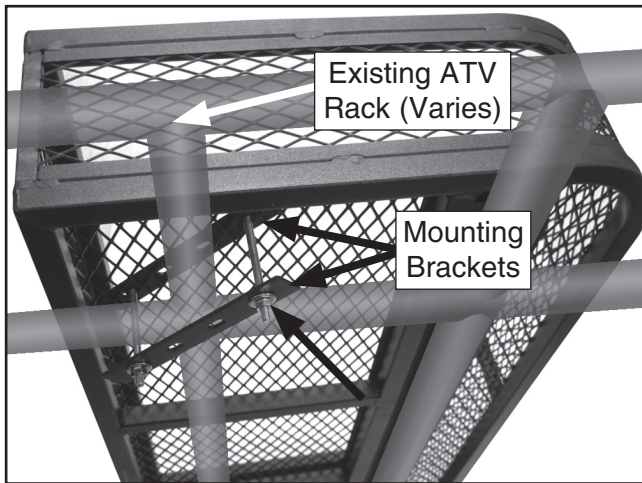

Figure 6. Installation (viewed from beneath).

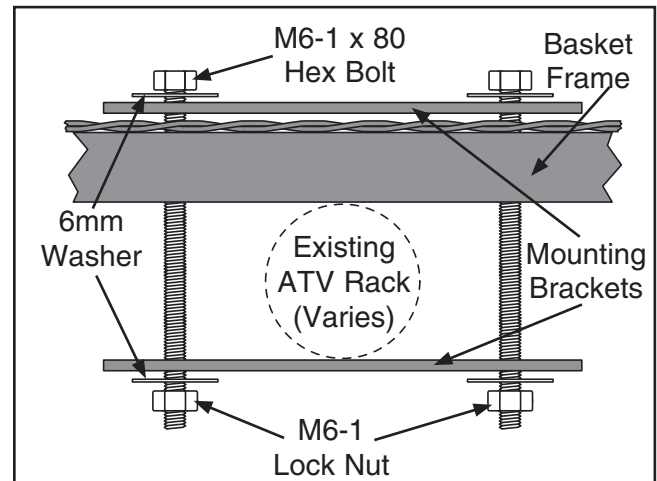

Figure 7. Installation hardware diagram.

! CAUTION

Check the manufacturer's recommended weight capacity for your existing ATV and ATV rack. Failure to comply with manufacturer's capacities may result in damage to your ATV and create a hazardous situation.



T10040 Parts Breakdown and List

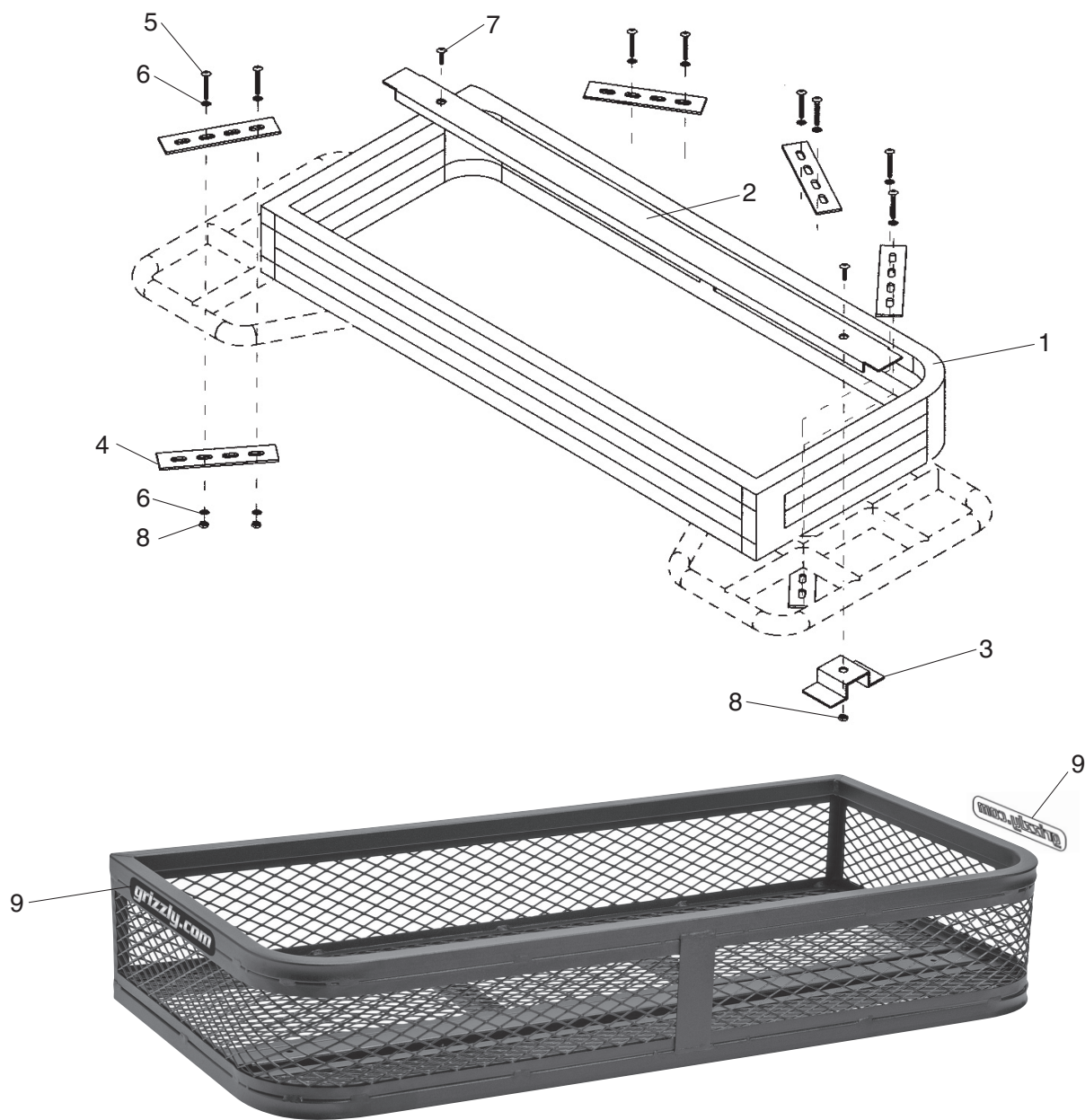

REF	PART #	DESCRIPTION
1	PT10040001	BASKET
2	PT10040002	FILLER PLATE
3	PT10040003	FILLER PLATE CLAMP
4	PT10040004	MOUNTING BRACKETS
5	PB119M	HEX BOLT M6-1 X 60

REF	PART #	DESCRIPTION
6	PW03M	FLAT WASHER 6MM
7	PB83M	HEX BOLT M6-1 X 16
8	PLN03M	LOCK NUT M6-1
9	PT10040009	GRIZZLY.COM LABEL